

TOTAL NO. OF PLAT = 330 NOS		
REV. TOTAL FLOOR AREA INCLUDING COR. $C \times D = 100.0 \times 100.0 = 10000.00$ M ² TO BE IN 30 DAY		
STATED TOTAL FLOOR AREA INCLUDING COR. $C \times D = 100.0 \times 100.0 = 10000.00$ M ² TO BE IN 30 DAY		
CAR PARKING CALCULATION		
TOTAL NO. OF REG. CAR PARKING	2000 / 100	2000 / 100
	20000 / 100	20000 / 100
	20000 / 100	20000 / 100
PROPOSED AREA OF CAR PARKING	NO. OF CAR	NO. OF CAR
	2000 / 100	2000 / 100
TOTAL NO. OF PROPOSED CAR PARKING	2000 / 100	2000 / 100
	20000 / 100	20000 / 100
PROPOSED AREA OF CAR PARKING	2000 / 100	2000 / 100

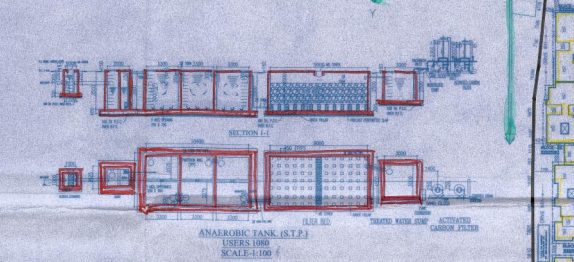

CALCULATION FOR NO. OF HEADS		
BLOCK-1		
TYPE OF FLAT	NO. OF FLATS	NO. OF HEADS
3 B. RM.	154 FL. = 4	
2 B. RM.	294 FL. = 8	1205
TOTAL =	12	60
BLOCK-2A TO 2H		
TYPE OF FLAT	NO. OF FLATS	NO. OF HEADS
3 B. RM.	(10-20RM) = 96	
2 B. RM.	(294-20RM) = 104	2085
TOTAL =	200	1000

TYPE OF FLAT	NO. OF FLATS	NO. OF HEADS
1 B. FL.	2 + 3% FL. = 20	42%
2 B. FL.	4 + 3% FL. = 22	
TOTAL =	42	

1.0. 200	2.0. 100	4.0. 50
2.0. 100	4.0. 50	8.0. 25
4.0. 50	8.0. 25	16.0. 12.5
8.0. 25	16.0. 12.5	32.0. 6.25
16.0. 12.5	32.0. 6.25	64.0. 3.125
32.0. 6.25	64.0. 3.125	128.0. 1.5625
64.0. 3.125	128.0. 1.5625	256.0. 0.78125
128.0. 1.5625	256.0. 0.78125	512.0. 0.390625
256.0. 0.78125	512.0. 0.390625	1024.0. 0.1953125
512.0. 0.390625	1024.0. 0.1953125	2048.0. 0.09765625
1024.0. 0.1953125	2048.0. 0.09765625	4096.0. 0.048828125
2048.0. 0.09765625	4096.0. 0.048828125	8192.0. 0.0244140625
4096.0. 0.048828125	8192.0. 0.0244140625	16384.0. 0.01220703125
8192.0. 0.0244140625	16384.0. 0.01220703125	32768.0. 0.006103515625
16384.0. 0.01220703125	32768.0. 0.006103515625	65536.0. 0.0030517578125
32768.0. 0.006103515625	65536.0. 0.0030517578125	131072.0. 0.00152587890625
65536.0. 0.0030517578125	131072.0. 0.00152587890625	262144.0. 0.000762939453125
131072.0. 0.00152587890625	262144.0. 0.000762939453125	524288.0. 0.0003814697265625
262144.0. 0.000762939453125	524288.0. 0.0003814697265625	1048576.0. 0.00019073486328125
524288.0. 0.0003814697265625	1048576.0. 0.00019073486328125	2097152.0. 9.5367431640625E-05
1048576.0. 0.00019073486328125	2097152.0. 9.5367431640625E-05	4194304.0. 4.76837158203125E-05
2097152.0. 9.5367431640625E-05	4194304.0. 4.76837158203125E-05	8388608.0. 2.384185791015625E-05
4194304.0. 4.76837158203125E-05	8388608.0. 2.384185791015625E-05	16777216.0. 1.1920928955078125E-05
8388608.0. 2.384185791015625E-05	16777216.0. 1.1920928955078125E-05	33554432.0. 5.9604644775390625E-06
16777216.0. 1.1920928955078125E-05	33554432.0. 5.9604644775390625E-06	67108864.0. 2.9802322387695312E-06
33554432.0. 5.9604644775390625E-06	67108864.0. 2.9802322387695312E-06	134217728.0. 1.4901161193847656E-06
67108864.0. 2.9802322387695312E-06	134217728.0. 1.4901161193847656E-06	268435456.0. 7.450580596923828E-07
134217728.0. 1.4901161193847656E-06	268435456.0. 7.450580596923828E-07	536870912.0. 3.725290298461914E-07
268435456.0. 7.450580596923828E-07	536870912.0. 3.725290298461914E-07	1073741824.0. 1.862645149230957E-07
536870912.0. 3.725290298461914E-07	1073741824.0. 1.862645149230957E-07	2147483648.0. 9.313225746154785E-08
1073741824.0. 1.862645149230957E-07	2147483648.0. 9.313225746154785E-08	4294967296.0. 4.656612873077392E-08
2147483648.0. 9.313225746154785E-08	4294967296.0. 4.656612873077392E-08	8589934592.0. 2.328306436538696E-08
4294967296.0. 4.656612873077392E-08	8589934592.0. 2.328306436538696E-08	17179869184.0. 1.164153218269348E-08
8589934592.0. 2.328306436538696E-08	17179869184.0. 1.164153218269348E-08	34359738368.0. 5.82076609134674E-09
17179869184.0. 1.164153218269348E-08	34359738368.0. 5.82076609134674E-09	68719476736.0. 2.91038304567337E-09
34359738368.0. 5.82076609134674E-09	68719476736.0. 2.91038304567337E-09	137438953472.0. 1.455191522836685E-09
68719476736.0. 2.91038304567337E-09	137438953472.0. 1.455191522836685E-09	274877906944.0. 7.275957614183425E-10
137438953472.0. 1.455191522836685E-09	274877906944.0. 7.275957614183425E-10	549755813888.0. 3.637978807091712E-10
274877906944.0. 7.275957614183425E-10	549755813888.0. 3.637978807091712E-10	1099511627776.0. 1.818989403545856E-10
549755813888.0. 3.637978807091712E-10	1099511627776.0. 1.818989403545856E-10	2199023255

TOTAL NO. OF HEAD FOR PH-2= 630
TOTAL HEAD = 1890 NOS.
CAPACITY WATER DEMAND = 130 LTR / DAY

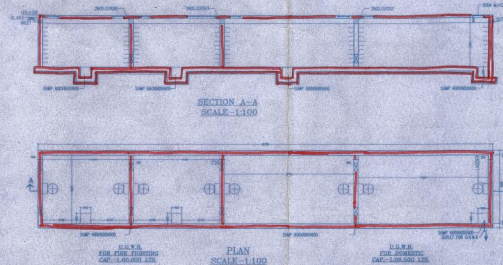

TYPE	SILL	UNIT	SIZE	WF	SILL	UNIT	SIZE
0	---	2100	1500x2100	#1	275	2100	1800x1825
01	---	2100	1100x2100	#2	275	2100	1500x1825
02	---	2100	900x2100	#3	275	2100	1200x1825
03	---	2100	825x2100	#4	275	2100	900x1825
04	---	2100	750x2100	#K1	1050	2100	900X1050
DW1	---	2100	1800x2100	#M2	1050	2100	750X1050
DW2	---	2100	1500x2100	#S1	900	2100	1200x1200
DW3	---	2100	1500x2100	#S2	900	2100	1200x1200
DW4	---	2100	1450x2100	#V1	1200	2100	600X900

GENERAL NOTES

1. ALL DIMENSIONS ARE IN MM.
2. ALL EXTERNAL WALLS 250TH. & 200TH. & INTERNAL WALLS 125 & 75 THK. UNLESS OTHERWISE MENTIONED.
3. ALL MASONRY WORKS ARE BOUNDED BY CEMENT MORTAR (1:6) & (1:4).
4. EXTERNAL PLASTER IS 25TH. & INTERNAL PLASTER IS 12MM TH. WITH 1:4 MORTAR.
5. ALL CONC. GRADE IS M200 (1:1.5:3).

CERTIFICATE OF STRUCTURAL ENGINEER

CERTIFIED THAT, "THE STRUCTURAL DESIGN & DRAWINGS OF BOTH FOUNDATION & SUPER STRUCTURE OF THE BUILDING HAS BEEN MADE BY ME CONSIDERING ALL POSSIBLE LOADS INCLUDING THE SEISMIC LOAD AS PER THE NATIONAL BUILDING CODE OF INDIA & CERTIFIED THAT IT IS SAFE & STABLE IN ALL RESPECTS"

SUBIR CHANDRA SANYAL
B.C.E. A.M.I., STRUCT. E. (I)
E.B.S. NO. 840, CLASS-I
E.S.E. NO. 007, CLASS-I
RAIPUR-SONARPUR MUNICIPALITY

SIGNATURE OF STRUCTURAL ENGINEER

ALOK ROY
Enlisted Geotechnical Engineer
Rajpur-Sonarpur Municipality
No.- 008 / G.T. Eng. Class-I

SIGNATURE OF GEO-TECHNICAL ENGINEER

SIGNATURE OF STRUC. REVIEWER

CERTIFICATE OF ARCHITECT

THE E.B.S. HAS CERTIFIED ON THE PLAN ITSELF WITH FULL RESPONSIBILITY THAT THE BUILDING PLAN HAS BEEN DRAWN UP AS PER PROVISIONS OF WEST BENGAL MUNICIPAL BUILDING RULES 2007, AS AMENDED FROM TIME TO TIME AND THAT THE SITE CONDITION INCLUDING THE WIDTH OF THE ADJOINING ROAD CONFORM WITH THE PLAN AND IT IS A BUILDABLE SITE AND NOT A TANK OR A FILLED UP TANK.

Rajkumar Agarwal
Architect
Member of Council of
Architecture CA / 94 / 17940

SIGNATURE OF ARCHITECT

SIGNATURE OF OWNER

PROJECT

EXISTING G+IV (BL-1) STORIED (14.04MT MT), G+V (BL-2A TO 2F) STORIED (18.00 MT MT.) AND PROPOSED G+VII (BL-3A,3B & 3C) STORIED (25.00 MT MT.) RESIDENTIAL BUILDING AT HOLDING NO. 1529, DWARIR ROAD, MOUZA - DHAMAITALA, JL NO: 73, R.S. DAG NO.39,40,41,42,46,48,60-64,59,58,55,55 (P), 46(P), 43(P). L.R. DAG NO.27,44,45,46,49,50,51,52,53,55,59,60,62, 63, 47, LR KHATAN NO. 706-717,678,722,676,718, 681,719,677, 721, 680,720, 674,716,679,675. P.S. SONARPUR, DIST. 24 PARGANAS (SOUTH), WARD NO. 25 UNDER RAJPUR SONARPUR MUNICIPALITY.

TITLE	(EXISTING BLOCK : - 1, 2A TO 2H PROPOSED BLOCK : - 3A, 3B & 3C)
GROUND FLOOR PLAN, SITE PLAN, LOCATION PLAN, . DETAILS OF U.G.W.R. & S.T.P.	

DATE	JOB. NO.	DEALT	CHECKED	SHEET NO.
18/09/17	ARCH/555/2015	TUMPA		1/19
SCALE				

SCALE
1:250

ARCHITECT

N

RAJ AGRAWAL & ASSOCIATES
8B, ROYD STREET, KOLKATA - 16

STRUCTURAL CONSULTANT:-		
SCALE 1:250	Sanyalson Associates Consultant Pvt. Ltd. CONSULTANT PLANNER & STRUCTURAL ENGINEERS KANUNO PARK P-137	N  KOLKATA-84

SUBIR CHANDRA SANYAL
B.C.E., A.M.I., STRUCT. E. (I)
B.B.S. NO. 840, CLASS-I
E.S.E. NO. 007, CLASS-I
RAIPUR, SONARPUR MUNICIPALITY

SIGNATURE OF STRUCTURAL ENGINEER.

Checked by
[Signature]
(Raj Mathew)

APPROVAL OF S.A.E.

FOR OFFICE USE ONLY

APPROVED

Plan No. 201/Rev/02/25/28 Dated 06/11/2022

Valid Up-to 06/11/2022

M. Bhat

Partha Gupta
Municipal Engineer

[Signature]
06/11/22
Chairman

RAJAPUR-SONARPUR MUNICIPALITY